

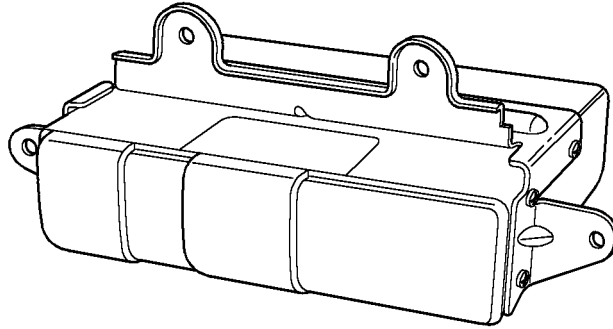

# Mopar®

**PARTS**



<b>GB</b>	INSTALLATION INSTRUCTION	<b>CD CHANGER</b>
<b>D</b>	EINBAUANLEITUNG	<b>CD-WECHSLER</b>
<b>E</b>	INSTRUCCIONES DE MONTAJE	<b>CAMBIADORES DE CD</b>
<b>F</b>	NOTICE DE MONTAGE	<b>CHANGEURS DE CD</b>
<b>I</b>	ISTRUZIONI DI MONTAGGIO	<b>CARICATORI CD</b>
<b>P</b>	INSTRUÇÕES DE MONTAGEM	<b>LEITOR PERMUTADOR DE CD</b>
<b>NL</b>	INBOUW-INSTRUCTIE	<b>CD-WISSELAARS</b>
<b>DK</b>	MONTERINGSVEJLEDNING	<b>CD-OMSKIETER</b>
<b>N</b>	MONTERINGSVEILEDNING	<b>CD-SKIFTERE</b>
<b>S</b>	MONTERINGSANVISNING	<b>CD-VÄXLARE</b>
<b>SF</b>	ASENNUSOHJE	<b>CD-VAIHTAJAT</b>
<b>CZ</b>	NÁVODK MONTÁŽ	<b>MENICE CD</b>
<b>H</b>	BESZERELÉS UTASÍTÁS	<b>CD-LEMEZ VÁLTÓ</b>
<b>PL</b>	INSTRUKCJA INSTALOWANIA	<b>ZMIENIACZE PLYT KOMPAKTOWYCH</b>
<b>GR</b>	ΟΔΗΓΙΕΣ ΕΓΚΑΤΑΣΤΑΣΗΣ	<b>ΠΡΟΩΘΗΤΕΣ CD</b>

Subject to alteration without notice  
Technische Änderungen vorbehalten  
Reservadas modificaciones técnicas  
Sous réserve de modifications techniques  
Con riserva di apportare modifiche tecniche  
Reservamo-nos o direito a alteracoes tecnicas  
Technische wijzigingen voorbehouden  
Med forbehold for tekniske indringer  
Tekniske forendringer forbeholdes  
Med reservation för tekniska ändringar  
Tekniset muutokset pidetään  
Technické zmeny vyhrazeny  
A változtatások technika jogát fenntartjuk  
Zmiany techniczne zastrzeżone  
Επιφύλασσόμεθα για αλλαγές

Expert Fitment Required  
Montage durch Fachwerkstatt erforderlich  
Montaje sólo por el concesionario  
Montage par spécialiste nécessaire  
E' necessario in officina specializzata  
Especialista em montagem requerido  
Montage door vakman nodig  
Montage ved professionelt værksted påkrævet  
Nødvendig med montering fra fagvejværksted  
Verkstadsmontage erfordras  
Asennus tarpeen merkkikorjaamossa  
Pozadována odborná montáž  
A szereléshez szakműhely kell  
Konieczny montaż przez warsztat specjalistyczny  
Για την τοποθέτηση απαιτείται εμπειρία

03-13-2001

**DAIMLERCHRYSLER**

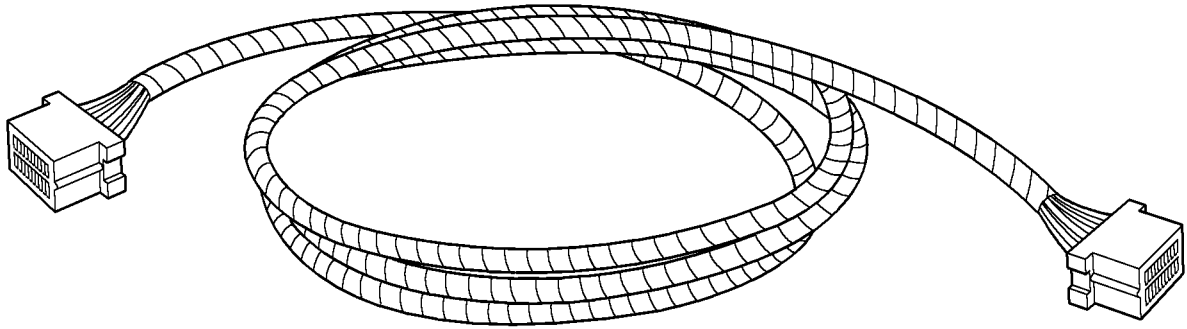

**A**

4x

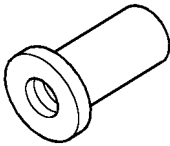

**B**

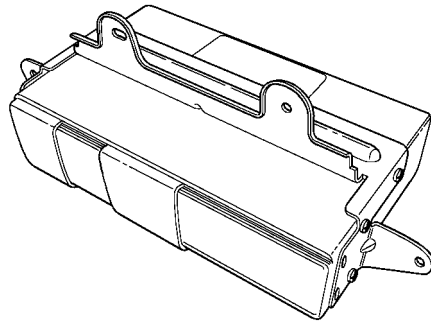

**C**

4x

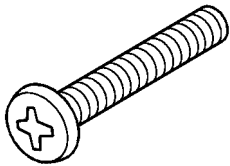

**D**

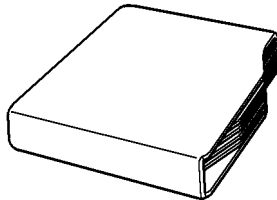

**E**

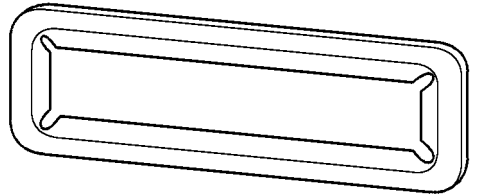

**F**

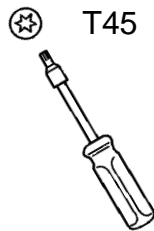

T45

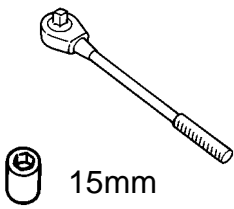
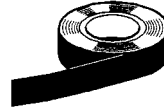

15mm

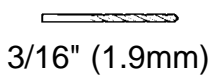

3/16" (1.9mm)

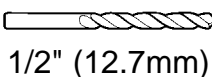

1/2" (12.7mm)

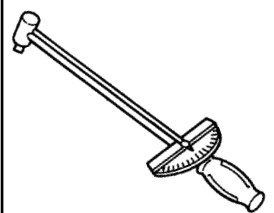
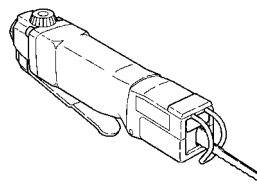
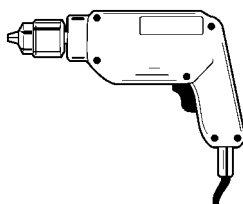

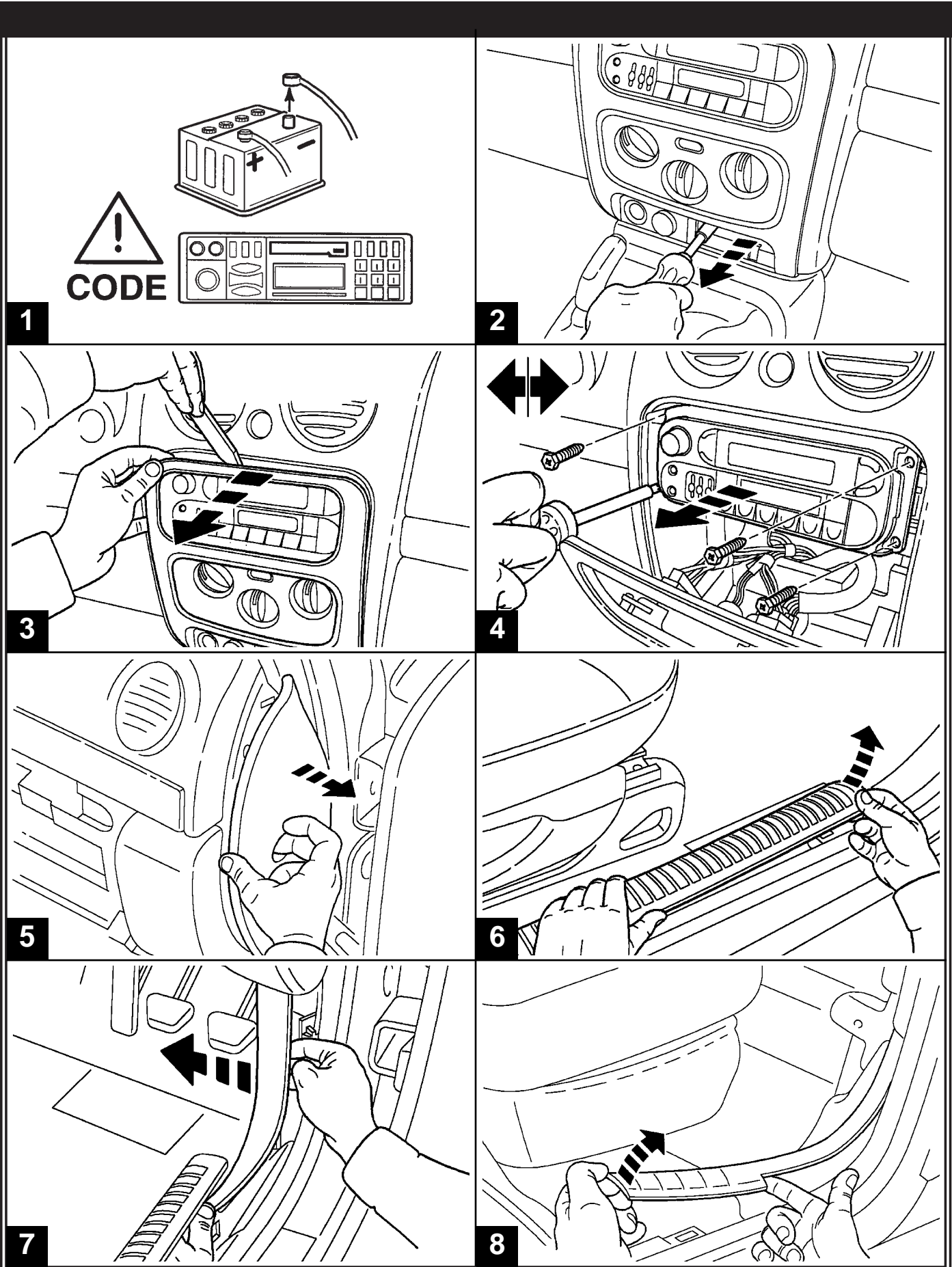

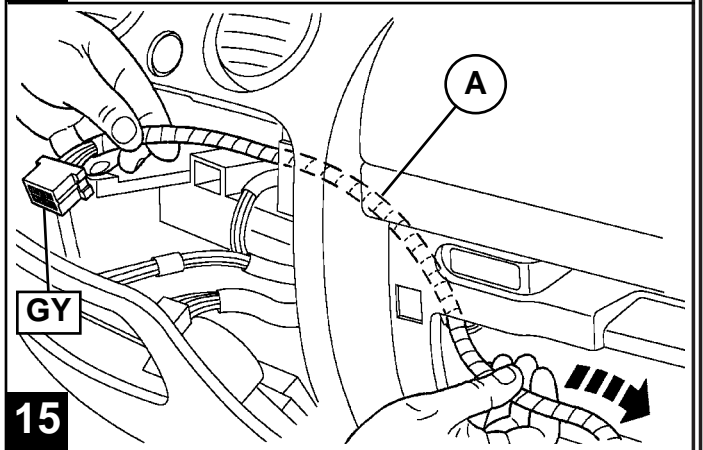
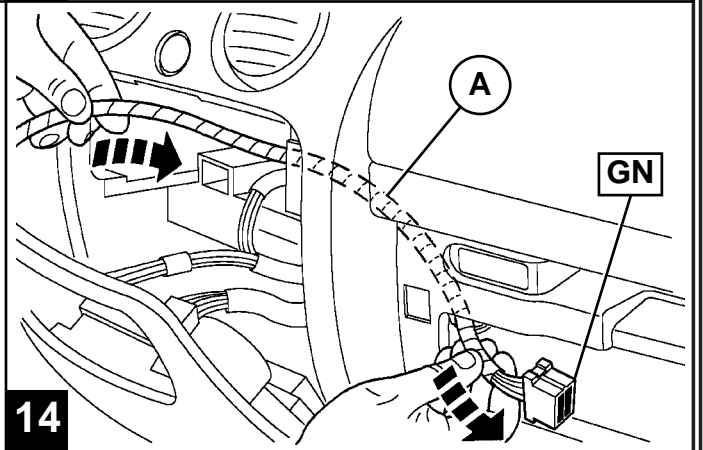
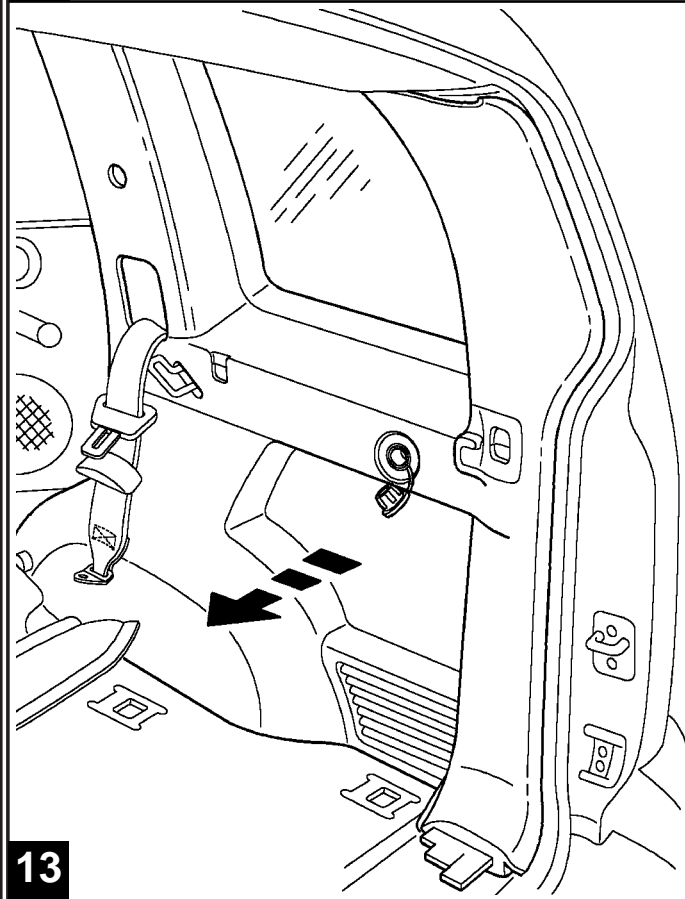
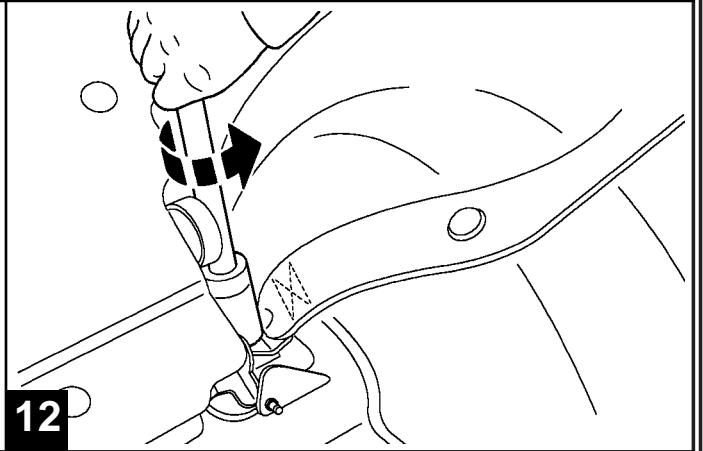
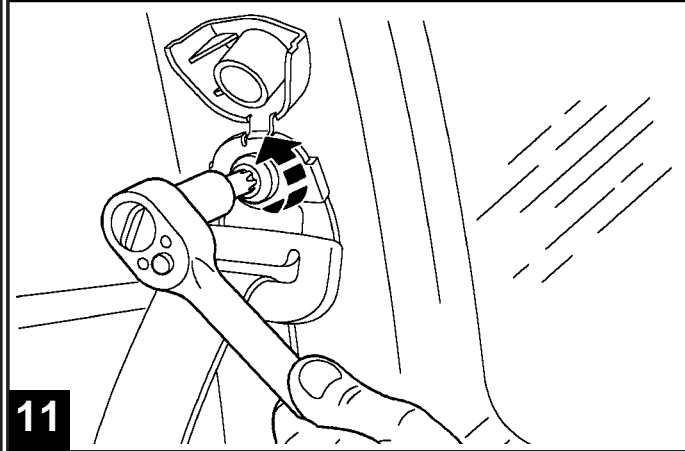
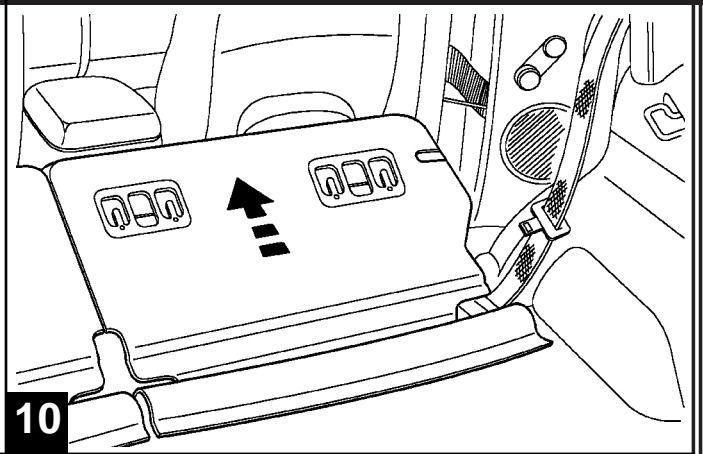
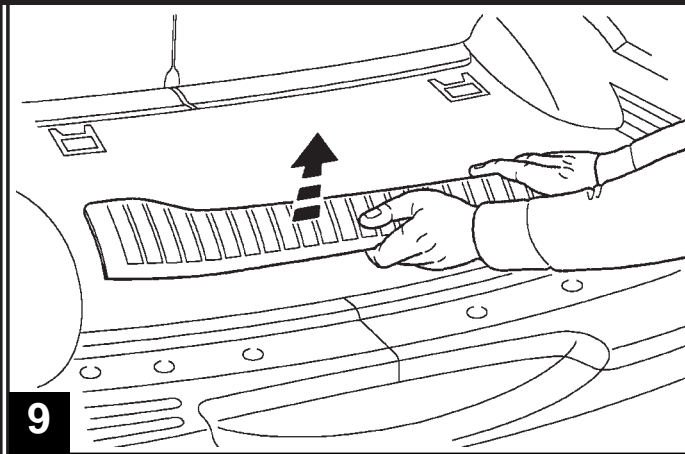

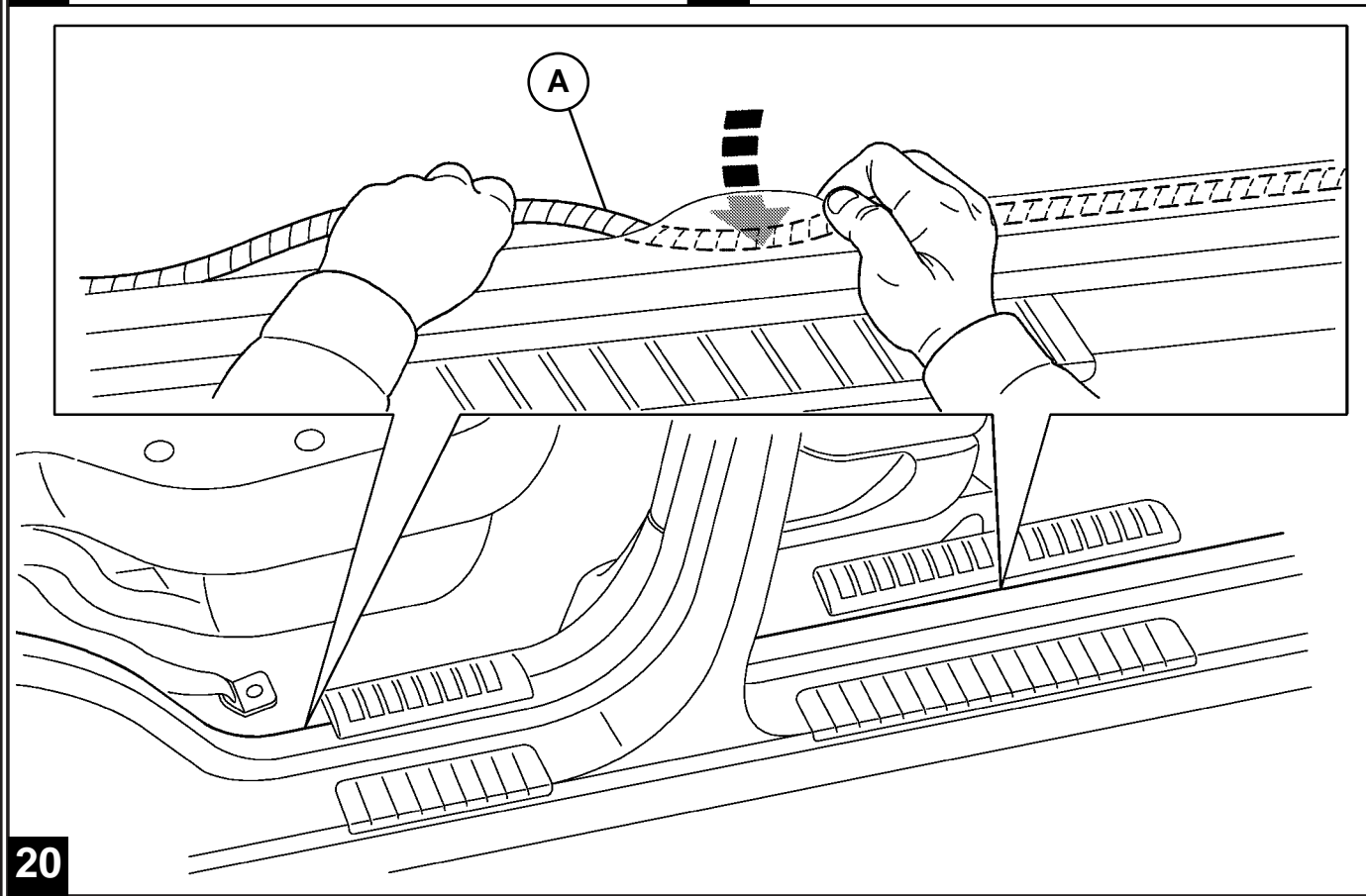
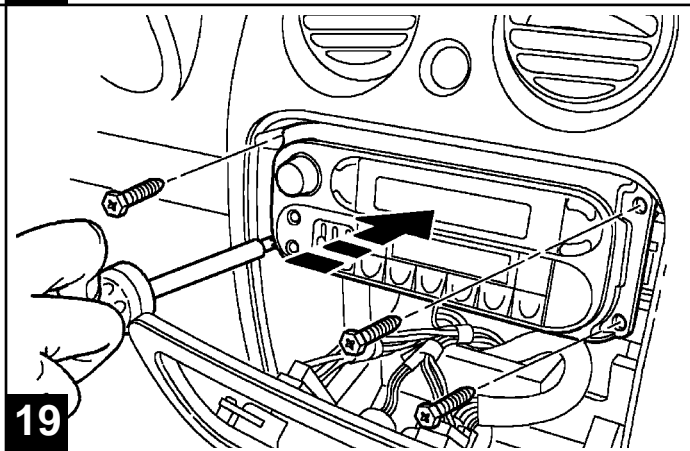
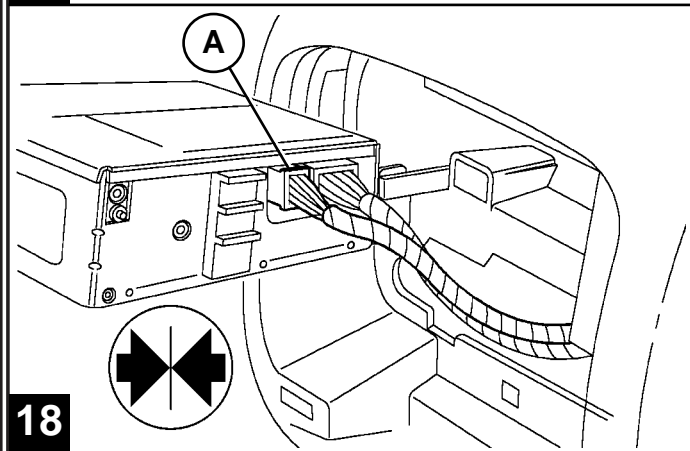
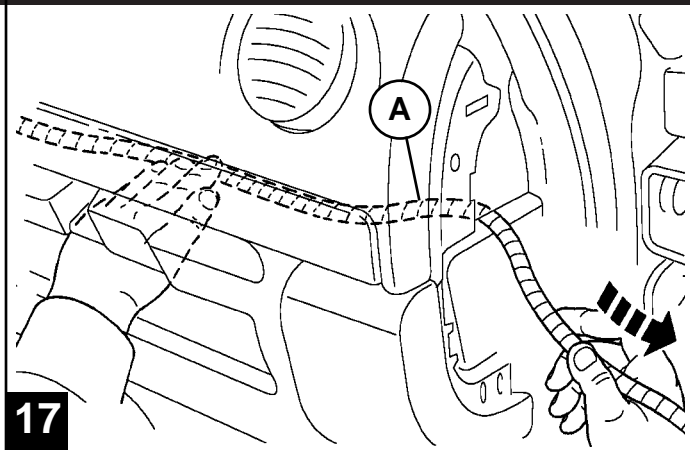
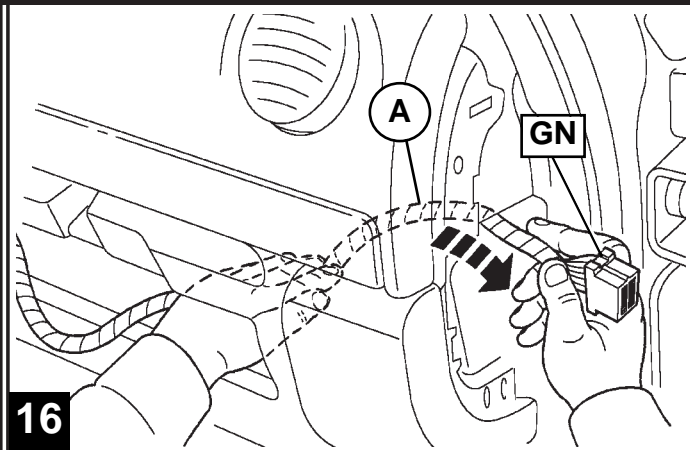

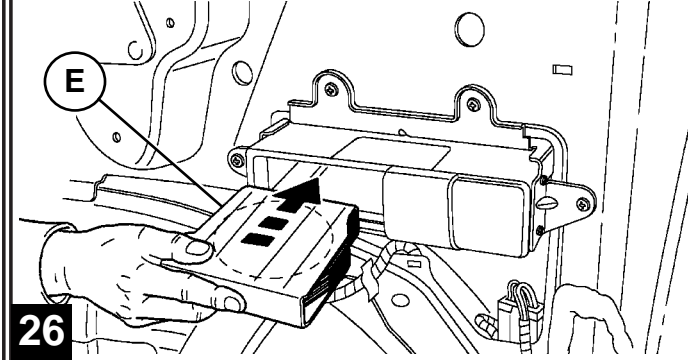
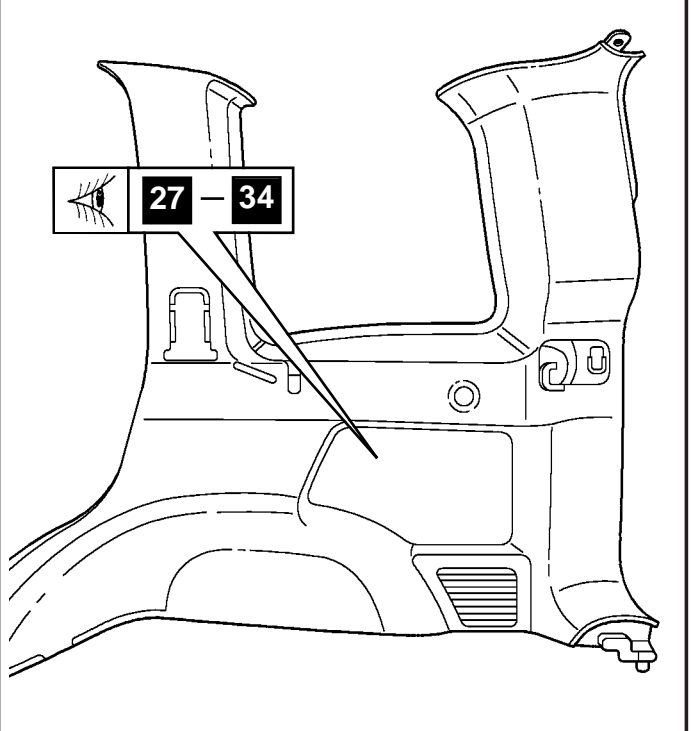
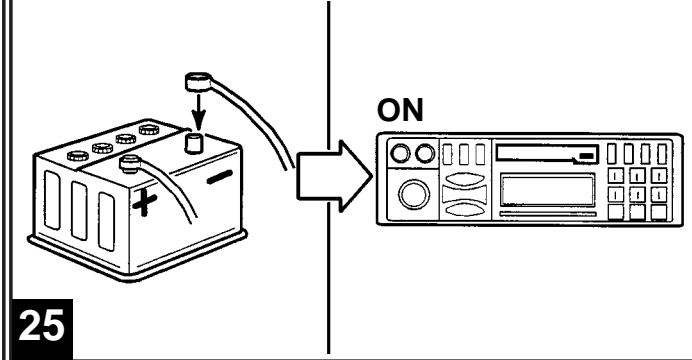
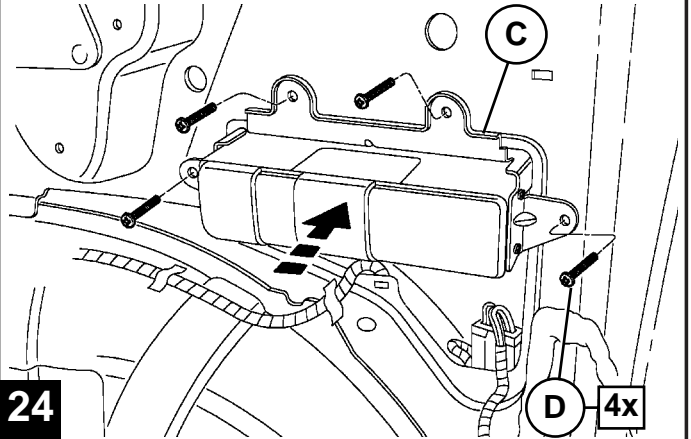
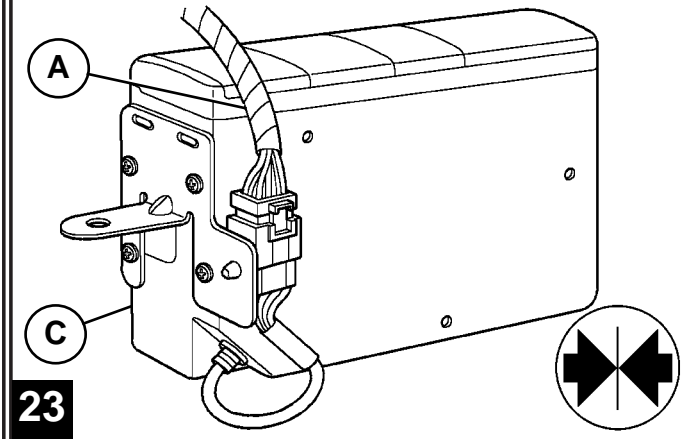
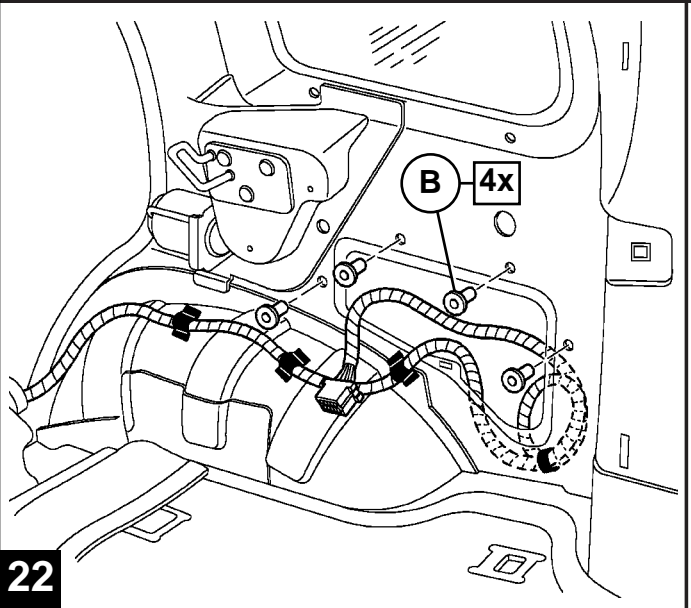
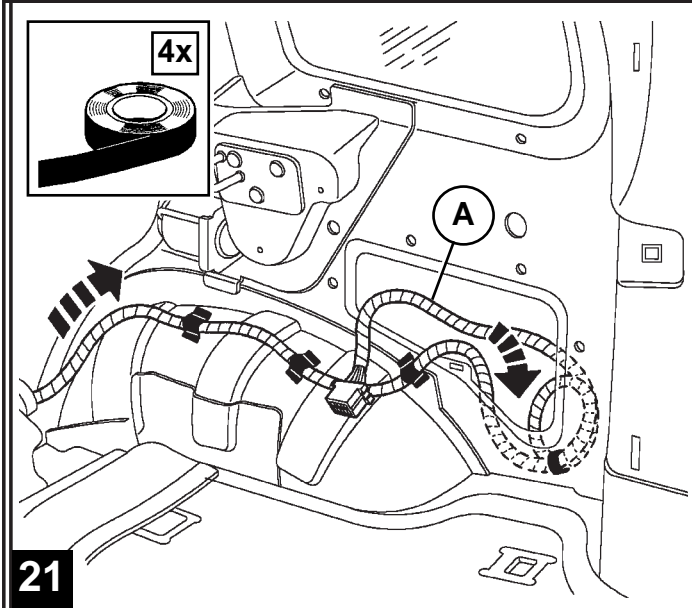

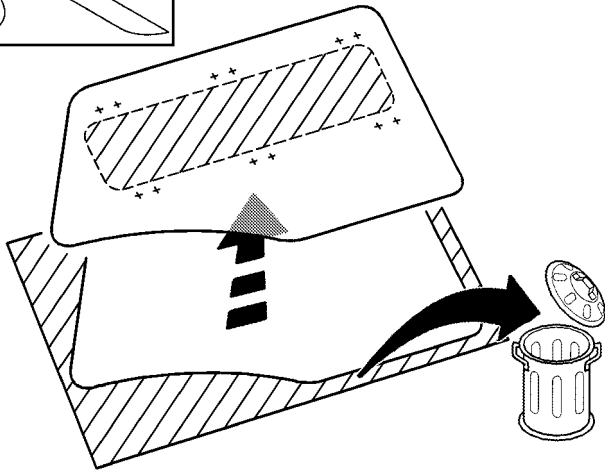
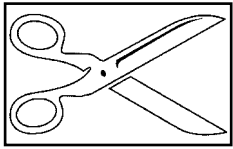

27

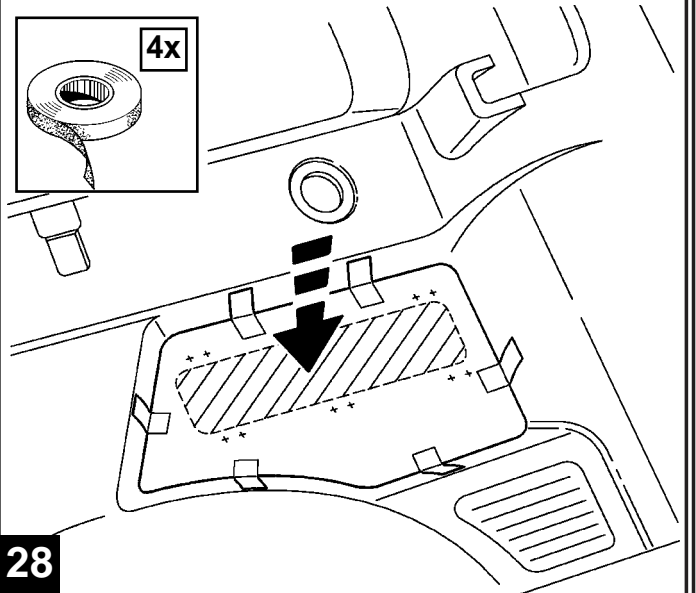
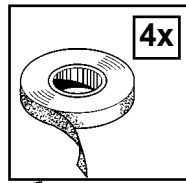

28

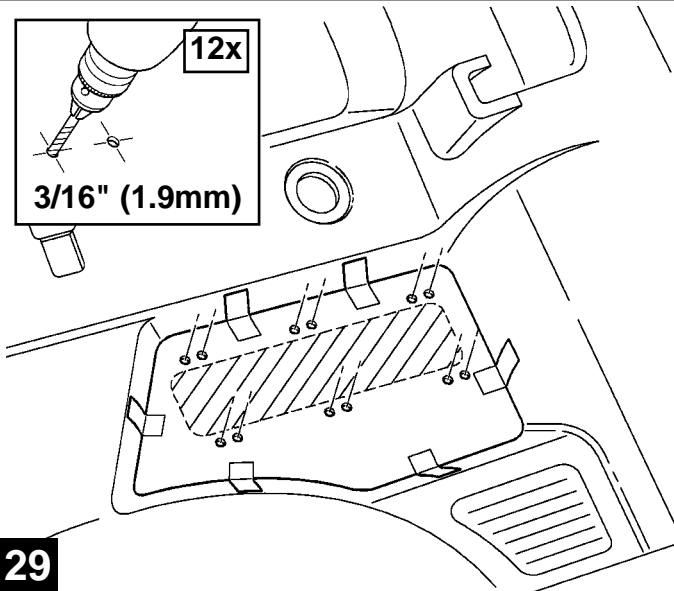
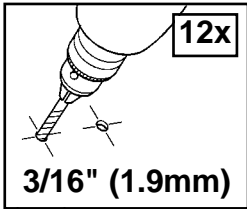

29

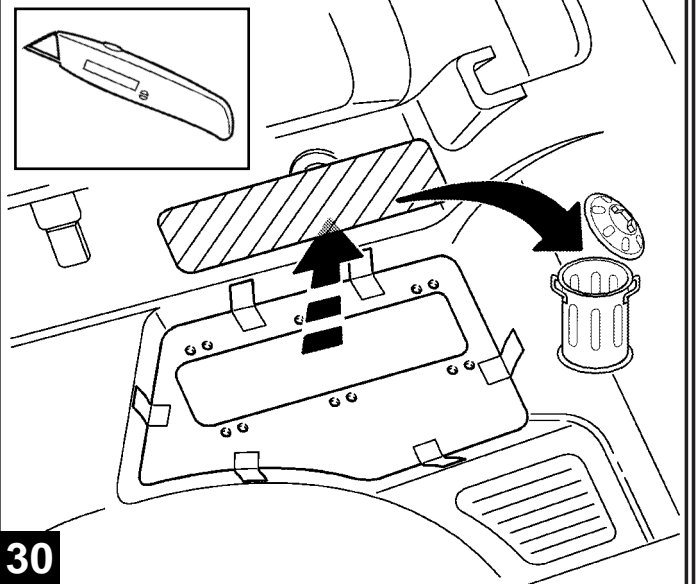
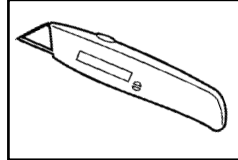

30

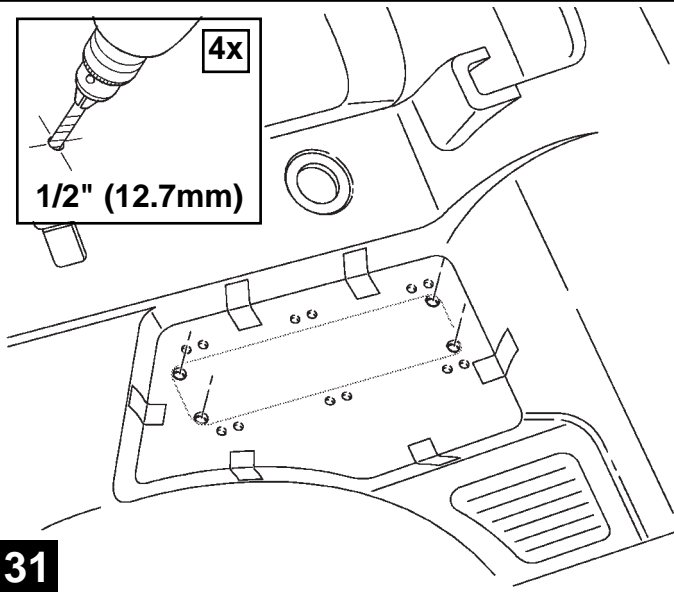
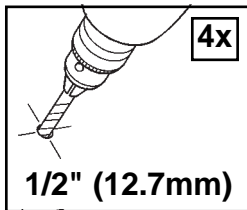

31

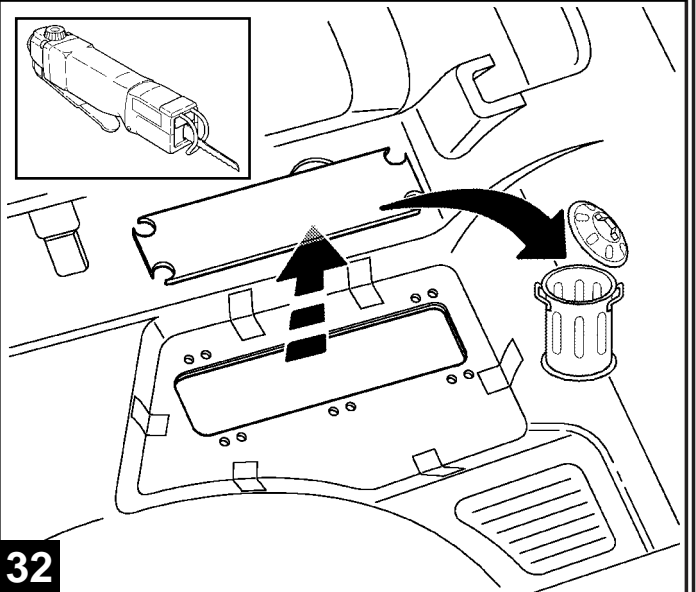
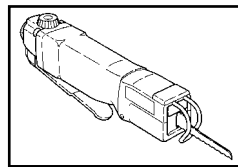

32

